

# RIGID INSULATION



**NEW CONSTRUCTION  
OR RENOVATION**

# ISOLOFOAM

# HIGH-QUALITY PRODUCTS

- Designed and manufactured in Canada.
- Tested and proven.
- Lightweight and easy to install.

## FOR NEW CONSTRUCTION OR RENOVATION

- Meet building code standards and the highest insulation requirements.

## ENVIRONMENTALLY FRIENDLY

- Free of ozone-depleting HFCs.
- Contain recycled materials.
- 100% recyclable and reusable.
- Greenguard and Greenguard Gold certified products.



## PERFECT FOR SUSTAINABLE CONSTRUCTION

- Contribute to LEED credits.
- Meet the requirements of high energy efficiency construction programs such as: ENERGY STAR | Passive House.

## COMFORT, SAVINGS, AND ENERGY EFFICIENCY GUARANTEED

# A COMPLETE LINE OF EFFICIENT INSULATION PRODUCTS



## ABOVE GROUND WALL INSULATION

### EXTERIOR **ISOCLAD**

AIR BARRIER/NON VAPOUR BARRIER INSULATION PANEL WITH A LAMINATED MEMBRANE

## ABOVE GROUND WALL INSULATION

### EXTERIOR **ISOBRACE**

EXPANDED POLYSTYRENE INSULATION PANEL LAMINATED TO A 7/16" ORIENTED STRAND BOARD (OSB) WITH OR WITHOUT A MEMBRANE

## ABOVE GROUND WALL INSULATION

### EXTERIOR **ISOSHIELD** PREMIUM NVB

GRAPHITE-ENHANCED POLYSTYRENE INSULATION FACED ON BOTH SIDES WITH A PERFORATED METALIZED FILM

## FOUNDATION WALL INSULATION

### INTERIOR **ISOFOIL**

RIGID INSULATION PANEL WITH A LAMINATED REFLECTIVE VAPOUR BARRIER MEMBRANE

## UNDER SLAB INSULATION

### **IFLEXFOAM**

INSULATION PANEL WITH A LAMINATED MEMBRANE ON EACH SIDE AND THE ISOCCLICK CLIPPING SYSTEM

## HYDRONIC RADIANT FLOOR INSULATION

### **ISORAD** v2

INSULATION PANEL WITH A MULTIDIRECTIONAL TUBING RETAINING DESIGN AND THE ISOCCLICK ALIGN CLIPPING SYSTEM

## VERSATILE INSULATION

### **ISOLOFOAM** HD 160 | XHD 200 | 300

RIGID HIGH-DENSITY INSULATION  
SLAB | FOUNDATION | WALL | FLOOR | CEILING

**COMFORT  
SAVINGS  
ENERGY EFFICIENCY**

# YOUR PROJECT

## RESIDENTIAL CONSTRUCTION

### INSULATION REQUIREMENTS PROVINCE OF ONTARIO

## MEET THE 2024 ONTARIO BUILDING CODE

- Various compliance packages
- Requirement for continuous insulation to eliminate thermal bridging
- Airtightness option

### Thermal bridge

Regulations require that building components creating a thermal bridge are covered with an insulating material. The insulating material must cover the thermal bridge from the exterior, the interior or a combination of both.



### Airtightness

Meeting the performance targets can reduce the insulation requirements in a chosen compliance package.

## GET STARTED

New constructions are built according to a chosen compliance package. The compliance package is often chosen by your professional.

**First**, you may identify whether the construction will be in zone 1 or 2.

**Second**, you may choose your compliance package.

Compliance packages are classified in 3 tables divided according to furnace efficiency or electric heating:

- **Table A** → AFUE  $\geq$  92% efficient (including solid fuel and earth energy systems)
- **Table B** →  $84\% \leq$  AFUE < 92% efficient (mid-efficient oil furnaces and boilers)
- **Table C** → Electrically heated homes

To know more about these compliance packages and airtightness targets details, refer to the 2024 Ontario Building Code or visit our website.

## RENOVATION

### Reduce air infiltration, cold zones, and your energy bill!

Inadequate insulation and poor airtightness can be the cause of cold floors and walls, condensation at the bottom of walls, and air currents.

Get comfort by improving the insulation and airtightness of the walls or the basement of your home.

### For help bringing your project to life

Stay informed!

Financial assistance and tax credit may be available; check with your municipality for details and to learn more about Canadian incentives available.

Get started today with Isofoam insulation products!

Visit [isofoam.com/grants](http://isofoam.com/grants) for more details on available incentives.

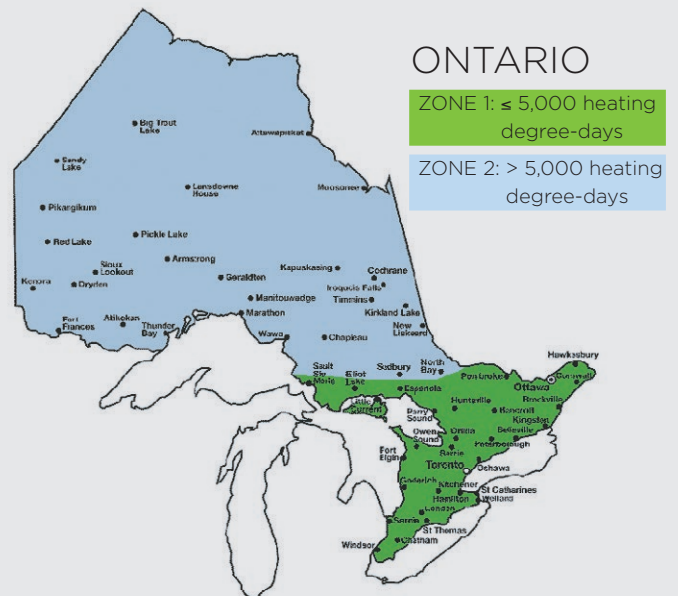

# ISOCLAD

ABOVE GROUND  
EXTERIOR WALL INSULATION



## AIR BARRIER/NON VAPOUR BARRIER INSULATION PANEL WITH A LAMINATED MEMBRANE

- Reduces the risk of mold: structure can breathe, allowing humidity contained in the walls to evaporate.
- Eliminates thermal bridges: creates a continuous insulating air barrier/weather barrier envelope.
- Reduces air infiltration and heat loss: contributes to maximizing wall insulation efficiency.
- Helps reaching airtightness targets. No other membrane needed. Easy to seal.
- Fast and easy to install thanks to its integrated membrane, especially with scaffolding.
- Installs on exterior building walls, maximizing living space.
- Can be installed on various types of structures and exterior sheathing.
- Shiplapped on 4 sides for better air and water tightness.
- 48" x 108": ideal size to insulate joists.
- A tried-and-tested product since 1998.

Evaluated by CCMC, #12981-R: Air barrier material  
Certified to CAN/ULC-S741: Intertek Spec ID 83259  
CAN/ULC-S741: Standard for Air Barrier Materials - Specification  
CAN/ULC-S742: Standard for Air Barrier Assemblies - Specification

To ensure airtightness of the assembly, refer to the installation guide.

## AVAILABLE DIMENSIONS

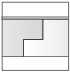
DIMENSIONS	THICKNESSES	R-VALUE
48" x 96" or 48" x 108"  Shiplapped 4 sides	3/4"	3
	1"	4.05
	1 1/4"	5.05
	1 1/2"	6.05
	2"	8.1
	2 1/4"	9.1
	2 1/2"	10.1

Also available: 48" x 120", other thicknesses; butt edge or shiplapped on 2 sides.

## TYPICAL ASSEMBLY



Gypsum 1/2"  
Vapour barrier/air barrier  
Batt insulation R14, R19, R22 or R24  
**ISOCLAD** R5.05, R8.1 or R10.1  
Vinyl sheathing (non insulated)



Gypsum 1/2"  
Vapour barrier/air barrier  
Batt insulation R14, R19, R22 or R24  
OSB 7/16"  
**ISOCLAD** R5.05, R8.1 or R10.1  
Vinyl sheathing (non insulated)

Other assemblies possible. Illustrations for information purposes only.

## INSTALLATION TIPS<sup>1</sup>

- Install insulation on the wood studs, printed side facing the exterior.
- Temporarily attach with nails or screws and supporting washers.
- Seal all joints with an air barrier sealing tape.
- Seal all changes in surface with a sealant (openings, electrical outputs, etc.) and prepare window openings to ensure air and water tightness.
- Install 1" x 3" wood furring either vertically or diagonally (optional).
- Install exterior cladding.

Details and installation videos available on our website.

# ISOBRACE

ABOVE GROUND  
EXTERIOR WALL INSULATION



## EXPANDED POLYSTYRENE INSULATION PANEL LAMINATED TO A 7/16" ORIENTED STRAND BOARD (OSB)

- Provides continuous insulation: eliminates thermal bridges.
- Contributes to the structural strength of the building wall.
- Can eliminate the need to add temporary bracing.
- Perforated OSB panel at regular intervals maximize water vapour permeability.
- Fast and easy installation.
- Installs on exterior building walls. Maximizes living space.
- Can be installed on various types of structures and exterior sheathing.
- The 4'x 9' size makes thermal bridging insulation between joists easy.

### Get more with ISOBRACE AIR+

#### Continuous air and water barrier

- Creates a continuous air barrier. Air and weathertightness easy to achieve thanks to integrated membrane.
- No need to add another membrane when panels are sealed.
- Flashing easy to install by lifting the air barrier membrane.
- All-in-one product that eliminates multiple installations.

EPS insulation: Evaluated by CCMC, #12895-L: EPS Type 2  
OSB: CSA-0325 - W24, Exposure 1

## AVAILABLE DIMENSIONS

DIMENSIONS	THICKNESSES	R-VALUE
48" x 108"  Butt edge	1 5/16"	4.15
	1 9/16"	5.15
	1 13/16"	6.18
	2 3/16"	7.65

Also available: 48" x 96", other thicknesses.

## TYPICAL ASSEMBLY

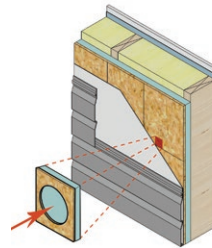

Gypsum 1/2"  
Vapour barrier/air barrier  
Batt insulation R14, R19, R22 or R24  
**ISOBRACE OSB** R5.15 or R7.65  
Air/weather barrier if required  
Vinyl siding (non insulated)

Other assemblies possible. Illustrations for information purposes only.

## INSTALLATION TIPS<sup>1</sup>

- Install panels with OSB and/or printed membrane facing outward, allowing the foam to be in direct contact with the framing, and ensure that all edges of the panel are well supported.
  - For new constructions, if installed in a seismically active / area, validate bracing requirements that apply.
- Attach panels with appropriate nails (twisted or ring nails).
  - Not more than 6" o/c along edge supports.
  - Not more than 12" o/c along intermediate supports.
- When installing ISOBRACE OSB, cover the product with an air/weather barrier membrane.
- When using ISOBRACE AIR+, seal all joints with sealing tape or a self-adhesive sealing membrane. Framing nails used for fixing the panel must be covered.
- Seal all changes in surface with a sealant (openings, electrical outputs, etc.) and prepare window openings to ensure air and water tightness.
- If required, install 1" x 3" wood furrings vertically or diagonally (if recommended by the siding manufacturer).
- Install the exterior finish.

Details and installation videos available on our website.

# ISOSHIELD PREMIUM NVB

ABOVE GROUND  
EXTERIOR WALL INSULATION



## GRAPHITE-ENHANCED POLYSTYRENE INSULATION FACED WITH A PERFORATED METALIZED FILM ON BOTH SIDES

- Faced with a non-reflective coated metalized film on the front and a reflective one on the back.
- Provides continuous insulation. Minimizes energy loss due to thermal bridges.
- Can be used as weather barrier.
- Can act as a second plane of protection when the joints are taped and sealed (OBC 9.27.3).
- Non vapour barrier. Both sides perforated to ensure water vapour permeance to reduce the risk of trapped moisture. No need to calculate dew point.
- Thanks to its laminated films on both sides, ISOSHIELD PREMIUM NVB is durable and flexible, makes installation on radius walls easier, and reduces site damage and waste.
- Lightweight product: handling and installation time are minimized.
- Cost-competitive sheathing insulation panel, easy to install and seal.

Made of expanded polystyrene with graphite particles. Offers a greater insulation value for a thickness equivalent to a traditional expanded polystyrene product.

Evaluated by CCMC, #12894-L: EPS Type 1

## AVAILABLE DIMENSIONS

DIMENSIONS	THICKNESSES	R-VALUE
 <p>Butt edge</p>	1 1/16"	5
	1 5/8"	7.64
	2 1/8"	10

Standard product: 10 psi (70 kPa).

Also available: 48" x 108" or 48" x 120", non-perforated films, other thicknesses.

## TYPICAL ASSEMBLY



Gypsum 1/2"  
Vapour barrier/air barrier  
Batt insulation R14, R19, R22 or R24  
OSB 7/16"  
**ISOSHIELD PREMIUM NVB**  
R5, R7.64 or R10  
Vinyl sheathing (non insulated)

Other assemblies possible. Illustrations for information purposes only.

## INSTALLATION TIPS<sup>1</sup>

### ISOSHIELD PREMIUM NVB used as a weather barrier:

- Install insulation on the OSB panel, printed side facing the exterior.
- Attach with nails or screws and supporting washers.
- Seal all joints with an air barrier sealing tape (optional).
- Seal all changes in surface with a sealant (openings, electrical outputs, etc.) and prepare window openings to ensure water tightness (optional).
- Install 1" x 3" wood furring either vertically or diagonally (optional).
- Install exterior cladding.

Can act as a second plane of protection when the joints are taped and sealed (OBC 9.27.3).

Details and installation videos available on our website.

# ISOFOIL

## INTERIOR FOUNDATION WALL INSULATION



### RIGID INSULATION PANEL WITH A LAMINATED REFLECTIVE VAPOUR BARRIER MEMBRANE

- Ensures continuous insulation and eliminates thermal bridges: improves comfort in the basement and reduces energy loss.
- Vapour barrier product: prevents humidity inside the building from contacting the cold concrete.
- Blends with imperfections in the concrete. Reduces the risk of condensation, mold and wall deterioration.
- Fast and easy to install thanks to its integrated membrane.
- Reflective membrane for better comfort. Rigid easy-to-seal vapour barrier.

Evaluated by CCMC, #13459-R: Effective thermal resistance of specific assemblies, including the reflective effect contribution in the R-value.

**OBC 2024:** Achieve the airtightness performance targets and reduce your construction cost.

If airtightness is achieved, ISOFOIL 3" could be used as a possible substitution for basement wall insulation (reduction to R15-continuous insulation). Save time and money with only one product to install.

Meeting the airtightness performance targets can reduce the requirements in a chosen package, including insulation. Ask your professional.

### AVAILABLE DIMENSIONS

DIMENSIONS	THICKNESSES	R-VALUE
48" x 96" or 48" x 100" 	2"	11*
Shiplapped on 2 sides	3"	15.5*

\* Thermal resistance in a wall system, according to installation recommendations.

See the CCMC (#13459-R) report for more details about the different wall assemblies evaluated and recognized by the Ministry of Municipal Affairs and Housing of Ontario.

### TYPICAL ASSEMBLY

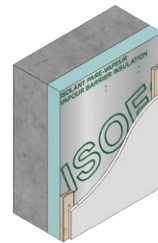

#### NEW CONSTRUCTION

Concrete wall 8"  
**ISOFOIL 3"**  
Wood furring 1" x 3" (at 24" o/c)  
Gypsum 1/2"

**Total: min. R<sub>eff</sub> = 18.06\***

\* See the CCMC (#13459-R) report for more details about the different wall assemblies evaluated and recognized by the Ministry of Municipal Affairs and Housing of Ontario.

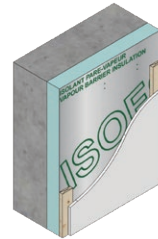

#### RENOVATION

Concrete wall 8"  
**ISOFOIL 2"**  
Wood furring 1" x 3" (at 24" o/c)  
Gypsum 1/2"

**Total: min. R<sub>eff</sub> = 13.22\*\***

\*\* See the other tested assemblies available on our website.

Other assemblies possible. Illustrations for information purposes only.

### INSTALLATION TIPS<sup>1</sup>

- Choose only from assemblies that meet requirements.
  - RENOVATION: Make sure to take care of cracks or infiltration issues before starting work.
- Install insulation vertically on the wall, reflective side facing the interior of the basement.
- Seal all joints with a reflective vapour barrier tape.
- Seal the joints where openings, floors and ceilings meet using a sealant (acoustic sealant, etc.) to not leave an air space between concrete wall and insulation.
- Depending on the chosen assembly, position the 1" x 3" furring at 16" or at 24" o/c or install the structure in front.
  - Ensure that the air spaces created by the furring or the structure are closed at the top, at the bottom and around openings to avoid air leaks.
- Mechanically attach insulation using concrete nails if required.
  - Nails must go about 1" into the concrete.
- Leave a space of about 1/4" to 1/2" between the concrete floor and the furring.
- Cover with a thermal barrier (gypsum).

Details and installation videos available on our website.

# iFLEXFOAM

## UNDER SLAB INSULATION



### FLEXIBLE AND RESISTANT INSULATION PANEL WITH A LAMINATED MEMBRANE ON EACH SIDE

- Ensure continuous and uniform insulation with the unique ISOCLICK 4-sided clipping system:
  - Once installed, panels are clipped together and remain in place during installation.
  - Panels are easily repositionable.
- Less breakage on the job site:
  - Laminated on 2 sides for greater resistance and flexibility.
  - No need to make a path for the wheelbarrow when pouring concrete.
- Fast and easy to install, guaranteeing you'll save time.
- High resistance to freezing, thawing, water and humidity.
- Excellent compressive strength: 16 psi (110 kPa), 30 psi (210 kPa).
- Perfect for insulating under the slab of a basement or under a light residential or commercial garage, regular or heated slab.

Evaluated by CCMC, #12895-L: EPS Type 2  
 Evaluated by CCMC, #13638-L: EPS Type 3

### TYPICAL ASSEMBLY

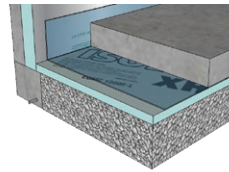

Concrete slab 5 1/2"  
 Vapour barrier  
**iFLEXFOAM** R5, R7.5 or R10  
 Compacted granular base

Illustrations for information purposes only.

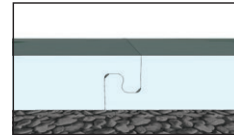
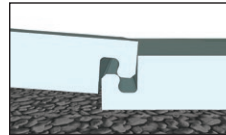

**PATENTED PRODUCT**

### AVAILABLE DIMENSIONS

DIMENSIONS	iFLEXFOAM	THICKNESSES	R-VALUE
48" x 96"  ISOCLICK 4 sides	<b>160</b>	1 1/4"	5.05
		1 7/8"	7.55
		2 1/2"	10.1
	<b>300</b>	1 3/16"	5.1
		1 3/4"	7.5
		2 3/8"	10.2

### INSTALLATION TIPS<sup>1</sup>

- Soil preparation: leveled and crushed granular base.
- Install insulating panels on the entire surface to be insulated.
  - Position the starting arrow at the corner of the wall to ensure efficient panel alignment.
- Install a vapour barrier polythene on the entire surface (if specified in your current regional building code) to ensure air, humidity and soil gas (radon) tightness.
- Install a wire mesh if required to reinforce the slab.
- Pour the concrete slab.

Details and installation videos available on our website.

# ISORAD<sup>V2</sup>

## UNDER SLAB INSULATION HYDRONIC RADIANT FLOOR HEATING

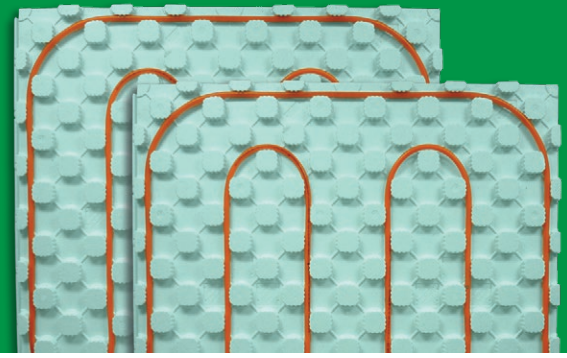

### INSULATION PANEL WITH A MULTIDIRECTIONAL TUBE RETAINING DESIGN AND THE ISOCCLICK ALIGN CLIPPING SYSTEM

- Insulation under the concrete slab.
- For hot water or glycol radiant floor systems.
- Ensures a continuous and uniform insulation:
  - Panels stay aligned and in place with the ISOCCLICK ALIGN 4-sided clipping system.
  - Prevents heat loss through the soil. Provides permanent energy savings.
- Multidirectional system for 1/2" and 5/8" tubing.
  - Avoids the necessity of installing wire mesh when not required for reinforcing the slab.
  - Less physically demanding and easy to install by 1 person.
- Excellent compressive strength: 16 psi (110 kPa), 25 psi (173 kPa).
- High resistance to freezing, thawing, water and humidity.
- Easier and faster overall installation compared to a traditional installation.
- Reduces the installation costs for a hydronic radiant floor system.

Evaluated by CCMC, #12895-L: EPS Type 2  
Evaluated by CCMC, #13638-L: EPS Type 3

Also available in R3 version for renovation or upper storey floor.

### AVAILABLE DIMENSIONS

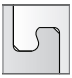
DIMENSIONS	THICKNESSES	R-VALUE	
		160	250
48" x 48" 	2 1/2" (overall: 3 1/2")	10.1	10.5
ISOCCLICK ALIGN 4 sides	3 3/4" (overall: 4 3/4")	15.1	15.7

For 1/2" tube (Ø int. 1/2", Ø ext. 5/8") or 5/8" tube (Ø int. 5/8", Ø ext. 3/4"). Also available: 24" x 48", other density [30 psi (210 kPa)].

### TYPICAL ASSEMBLY

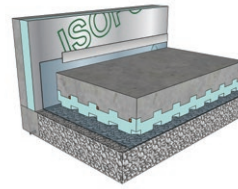

Concrete slab 5 1/2"  
Tubing  
**ISORAD V2** R10 or R15  
Vapour barrier  
Compacted granular base

Illustrations for information purposes only.

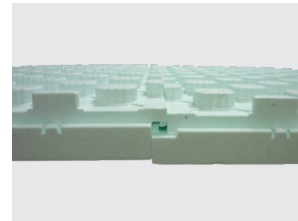

REGISTERED INDUSTRIAL DESIGN

### INSTALLATION TIPS<sup>1</sup>

- Soil preparation: leveled and crushed granular base.
- Install a vapour barrier polythene on the entire surface (if specified in your current regional building code) to ensure air, humidity and soil gas (radon) tightness.
- Install insulating panels on the entire surface to be insulated.
  - Position the starting arrow at the corner of the wall to ensure efficient panel alignment.
  - To start a new row by using the excess of a panel and ensure that notches are aligned, use the cutting lines on the back of the panel.
- Install the tubing by "walking" it in according to your design layout.
  - If needed, use tubing clips to fasten the tubes to the panel in tighter bends and with the heating system connection.
- Install a wire mesh if required to reinforce the slab.
- Pour the concrete slab.

Details and installation videos available on our website.

# ISOLOFOAM

## HD 160 | XHD 200 | 300

VERSATILE INSULATION  
SLAB | FOUNDATION | WALL | FLOOR | CEILING



### HIGH-DENSITY RIGID INSULATION

- Stable and permanent R-value: improves comfort and reduces energy loss.
- Versatile product suitable for several applications:
  - Non vapour barrier; can be installed on the exterior of walls.
  - Commonly used in applications under the level of the grade.
  - Can be used for residential garages.
- High resistance to freezing, thawing, water and humidity.
- Excellent compressive strength: 16 psi (110 kPa), 20 psi (140 kPa), 30 psi (210 kPa).
- Lightweight and available in a wide range of sizes and thicknesses.
- Fast and easy to install.
- Economical and efficient solution.

Evaluated by CCMC, #12895-L: EPS Type 2  
Evaluated by CCMC, #13638-L: EPS Type 3

### AVAILABLE DIMENSIONS

DIMENSIONS	ISOLOFOAM	THICKNESSES	R-VALUE
24" x 96" or 48" x 96"  Shiplapped 2 or 4 sides	HD 160	1"	4,05*
		1 1/4"	5,05
		1 7/8"	7,55
		2 1/2"	10,1
	XHD 200**	1"	4,2
		1,2"	5
		1,8"	7,55
		2,4"	10
		3,5"	14,7
	XHD 300	1"	4,3
		1 3/16"	5,1
		1 3/4"	7,5
2 3/8"		10,2	
		3 1/2"	15

Also available: other thicknesses, butt edge.

\* Product only offered with butt edge

\*\* ISOLOFOAM XHD 200 also offered in: 1" x 48" x 108", shiplapped 2 sides

### TYPICAL ASSEMBLY



#### ABOVE GROUND WALLS | EXTERIOR

Gypsum 1/2"  
Vapour barrier/air barrier  
Batt insulation  
**ISOLOFOAM HD 160** or **XHD**  
Vinyl sheathing (non insulated)



#### ABOVE GROUND WALLS | INTERIOR

Vinyl sheathing (non insulated)  
Air barrier membrane (optional)  
OSB 7/16"  
Batt insulation  
**ISOLOFOAM HD 160** or **XHD**  
Vapour barrier/air barrier  
Gypsum 1/2"

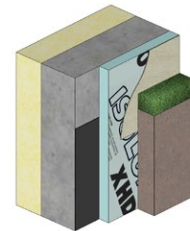

#### FOUNDATION | EXTERIOR AND INTERIOR

Basement blanket R12 or R20  
Concrete wall 8"  
Waterproofing  
**ISOLOFOAM HD 160** or **XHD** R5, R8, R10  
or R12  
Parging (above ground portion)  
Fill

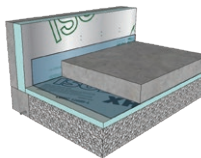

#### UNDER SLAB

Concrete slab 5 1/2"  
Vapour barrier  
**ISOLOFOAM HD 160** or **XHD** R5, R7.5  
or R10  
Compacted granular base

Other assemblies possible. Illustrations for information purposes only.

Installation tips on the following pages >

# ISOLOFOAM

## HD 160 | XHD 200 | 300

VERSATILE INSULATION

SLAB | FOUNDATION | WALL | FLOOR | CEILING



## INSTALLATION TIPS<sup>1</sup>

### ABOVE GROUND WALL INSULATION | EXTERIOR

- Install insulation on the wood studs.
- Temporarily attach with nails or screws and supporting washers.
- Add an air/wheater barrier if required. Seal all membrane joints with an air barrier sealing tape/membrane.
- Seal all changes in surface with a sealant (openings, electrical outputs, etc.) and prepare window openings to ensure air and water tightness.
- Install 1" x 3" wood furring (optional).
- Install exterior cladding.

### ABOVE GROUND WALL INSULATION | INTERIOR

- Install insulation on the wood studs.
- Temporarily attach with nails or screws and supporting washers.
- Add a vapour barrier membrane.
- Seal all joints with a vapour barrier sealing tape.
- Seal all changes in surface with a sealant (openings, electrical outputs, etc.) and prepare window openings to ensure air and water tightness.
- Install 1" x 3" wood furring (optional).
- Install thermal barrier (ex.: gypsum).

### FOUNDATION INSULATION | INTERIOR AND EXTERIOR

- Install basement blanket inside.
- Outside, ensure the French drain around the home is operational.
- Install a waterproofing product on the concrete wall.
- Install the insulation panels vertically on the entire height of the foundation.
- Fill in the soil.
- Cover the above ground part of the panels with acrylic coating or parging to protect from UV.

### UNDER SLAB INSULATION | NEW CONSTRUCTION

- Soil preparation: leveled and crushed granular base.
- Install insulation panels on the entire surface to be insulated.
- Install a vapour barrier polythene on the entire surface (if specified in your current regional building code) to ensure air, humidity and soil gas (radon) tightness.
- Install a wire mesh if required to reinforce the slab.
- Pour the concrete slab.

### OVER SLAB INSULATION | RENOVATION

- Existing concrete slab.
  - Make sure to take care of cracks or infiltration issues before starting to work.
- Install a vapour barrier polythene on the entire surface to ensure air, humidity and soil gas (radon) tightness (this step can be skipped if there is already an existing vapour barrier under the slab).
- Install 2" x 3" flat wood studs spaced apart 12" with a sill plate gasket under them.
- Install a section of R5 insulation panel between each stud.
- Install plywood or OSB.
- Install floor covering.

Visit [isolofoam.com/documentation](https://isolofoam.com/documentation) for all construction details for these applications.

Details and installation videos available on our website.

# ISOLOFOAM

## HD 160 | XHD 200 | 300

VERSATILE INSULATION  
SLAB | FOUNDATION | WALL | FLOOR | CEILING

# SUITABLE FOR THE MOST EXTREME USES

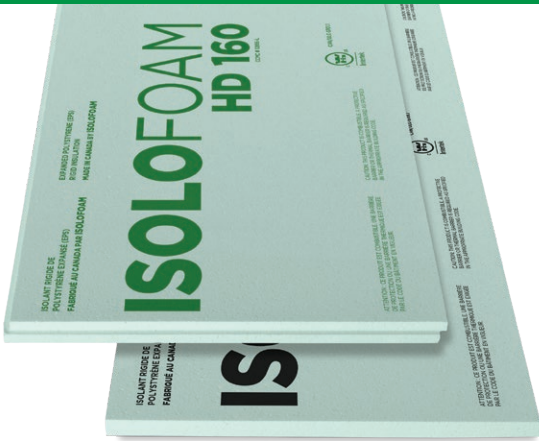

### LOAD CALCULATION RESIDENTIAL GARAGE

**FULLY loaded F-250 Pick-up**  
(total load of 5,000 kg)

ISOLOFOAM HD 160 (16 psi/110 kPa)

Exceeds compressive strength requirements\*

**+ 36%**

ISOLOFOAM XHD 200 (20 psi/140 kPa)

Exceeds compressive strength requirements\*

**+ 72%**

ISOLOFOAM XHD 300 (30 psi/210 kPa)

Exceeds compressive strength requirements\*

**+ 158%**

Also applicable for  
**iFLEXFOAM**

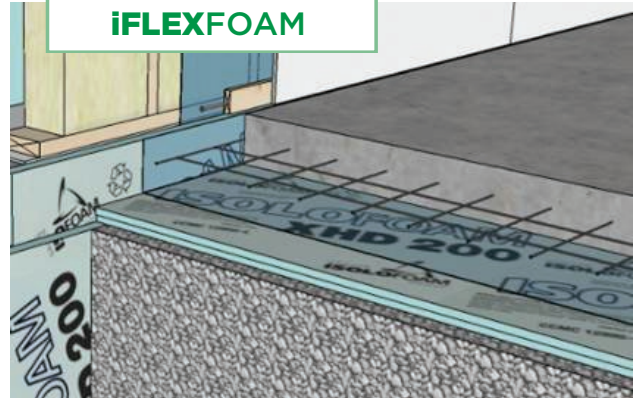

### PROJECT'S SLAB FEATURES

- 6", 25 MPa concrete slab.
- 6" x 6" 6/6 wire mesh.
- Vapour barrier membrane.
- ISOLOFOAM HD 160 or XHD insulation panels.
- Compacted granular base.

Refer to a professional to determine the required strength for a specific application.

# VARIOUS SECTORS OF ACTIVITY

# ISOFLLOT

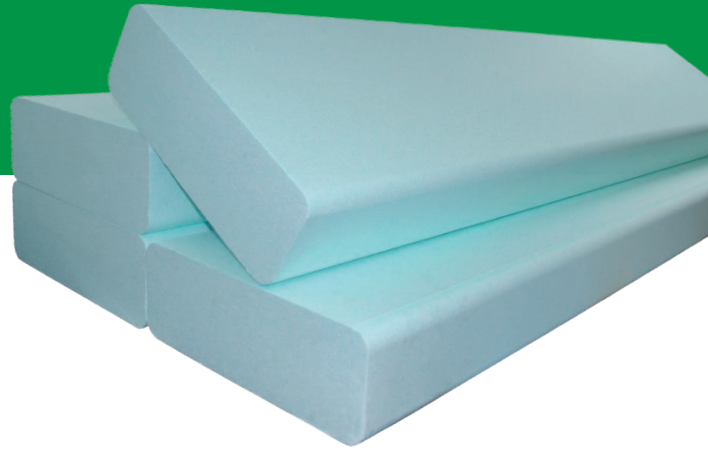

**WALL AND PREFAB HOME COMPONENTS**



**INSULATED CONCRETE FORMS**



**ROADS**



**LIGHTWEIGHT FILL**



**SMALL JOBS**

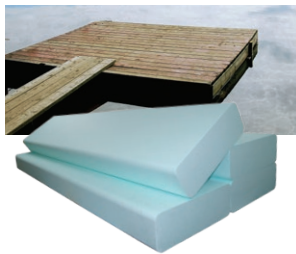

**FLOATING DOCKS**

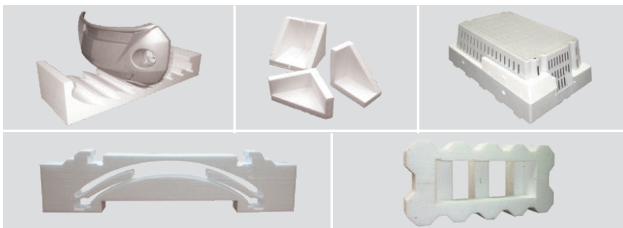

**PACKAGING SOLUTIONS AND CUSTOM COMPONENTS**

## BUOYANCY BILLETS FOR DOCKS AND FLOATING STRUCTURES

PERFECT FOR BUILDING FLOATING STRUCTURES SUCH AS FLOATING DOCKS, RAFTS, FLOATING BOAT SHELTERS, PONTOONS AND SLIPWAYS

- Efficient buoyancy.
  - Offers a buoyancy of 55 lb./cu. ft.
  - Offered in lengths of 8' for stable buoyancy.
  - Floating structures built with ISOFLLOT are adaptable to most shorelines.
- Excellent resistance.
  - Small percentage of water absorption (less than 2%).
  - Even when damaged, buoyancy is not affected.
  - Can be used in fresh or salt water.
- Durable and safe for the environment.
- Economical solution.

It is recommended to remove the structures from the water during winter or frost periods.

## PHYSICAL PROPERTIES

DIMENSIONS	VOLUME (ft <sup>3</sup> )	APPROX. WEIGHT	BUOYANCY
7" x 20" x 96"	7.77	12 lb.	425 lb.
10" x 20" x 96"	11.11	17 lb.	610 lb.

Details and installation videos available on our website.

# SUPPORT AVAILABLE

## A COMPREHENSIVE WEBSITE

isolof foam.com

- Complete documentation  
Find details on all products offered.
- Photos and videos  
View them to better understand a product and its application.
- Construction details and installation guides  
Find the one that suits your project.
- Dealer locator  
Easily find a dealer using our web application.

## TOLL-FREE LINE

1-800-463-8886

Readily available help and tips for your project.

## SOCIAL NETWORKS

Keep on top of the latest news by following us on our networks.



**LEGAL NOTICE** The assemblies and installation tips contained in this document are presented in good faith based on sources believed to be reliable. Since building codes, government regulations and conditions of use can change not only from one place to another but also over time, it is the customer's responsibility to determine if the product is suitable for the intended use and whether the workplace and practices comply with laws and applicable legislation.

# A **PARTNER** OF CHOICE

## **EXPERTS AT FINDING SOLUTIONS**

Isolofoam Group is renowned for its innovative and responsible thermal insulation solutions. The company has been investing in expanded polystyrene product research and development for more than 50 years.

Its insulation solutions are tested and proven and meet the highest insulation requirements in the industry.

Isolofoam Group is proud to offer construction and renovation specialists, dealers and consumers a complete line of products that stands out in the market.

