

# EFFICIENT INSULATION

RESIDENTIAL • COMMERCIAL  
INDUSTRIAL • INSTITUTIONAL



**ISOLOFOAM**  
GROUP

GROUP

# WHY CHOOSE ISOLOFOAM?

## HIGH QUALITY PRODUCT

- Tested and proven.
- Developed to meet the needs of professionals.
- New construction or renovation.
- Lightweight and easy to install.
- Meet Building Code standards and the highest insulation requirements.

## ENVIRONMENTALLY FRIENDLY

- Free of ozone-depleting HFCs and HCFCs.
- Contains recycled materials.
- 100% recyclable and reusable.
- **Greenguard** and **Greenguard Gold** certified products.



## PERFECT FOR SUSTAINABLE CONSTRUCTION

- Contributes to LEED credits.
- Meets the requirements of high energy efficiency construction programs.



You Tube

WATCH OUR VIDEOS ONLINE

## WHAT'S NEW?

# IFLEXFOAM

## UNDER SLAB INSULATION

### ELIMINATING IRRITANTS ON JOBSITE

- **ISOCLICK** clipping system. Once installed, panels are **clipped together** and remain in place during installation.
- **High resistance** to breakage. Laminated membrane on each side for **maximum flexibility**.
- **Fast** and **easy** installation.
- **Economic** solution.



Unique patent pending product

# ISORAD V2

## HYDRONIC RADIANT FLOOR HEATING

- Under slab insulation.
- **Multidirectional** tube **retaining** system facilitating installation and retention of tubing.
- **ISOCLICK ALIGN** 4 sides ensuring panels are aligned and clipped together.
- **Easy** and **quick installation** of insulation and tubing.

Unique patent pending product



# ISOBRACE OSB

## ABOVE GRADE WALL INSULATION

- Contributes to the **structural strength** of the building wall: **OSB 7/16"**.
- **Eliminates thermal bridging**: offers continuous insulation.
- Perforated OSB panel to maximize the **water vapor permeability**.
- Fast and easy installation.

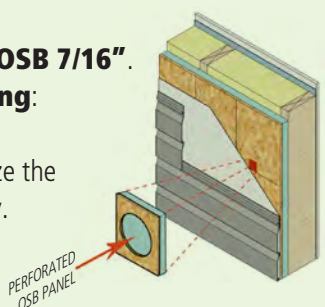



# EFFICIENT INSULATION

## ABOVE GRADE WALL INSULATION

### EXTERIOR ISOCLAD XS

AIR BARRIER/NON VAPOR BARRIER INSULATION PANEL WITH A LAMINATED MEMBRANE

- Reduces the risk of mildew: structure can breathe, allowing humidity contained in the walls to evaporate.
- Eliminates thermal bridges: creates a continuous air and weather barrier envelope.
- Reduces air infiltrations and heat loss.
- Shiplapped 4 sides for better air and water tightness.
- The 48" x 108" allows to insulate the joist.
- Fast and easy to install thanks to its integrated membrane, especially with built-in scaffolding.



#### DIMENSIONS

48" x 96" or 48" x 108" | Shiplapped 4 sides  
1/2" (R2) 3/4" (R3) 1" (R4) 1 1/4" (R5)  
1 1/2" (R6) 1 3/4" (R7) 2" (R8)  
Also available: other thicknesses; butt edge.

## ABOVE GRADE WALL INSULATION

### EXTERIOR ISOBRACE OSB

EXPANDED POLYSTYRENE INSULATION PANEL LAMINATED TO A 7/16" ORIENTED STRAND BOARD (OSB)

- Contributes to the structural strength of the building wall.
- Eliminates thermal bridging: offers continuous insulation.
- Perforated OSB panel to maximize the water vapor permeability.
- Fast and easy installation.

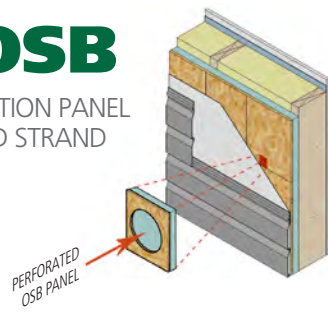

#### DIMENSIONS

48" x 96" or 48" x 108" | Butt edge  
1 5/16" (R4.1) 1 9/16" (R5.2) 2 3/16" (R7.6)

## INSULATION FOR WALL & CEILING

### INTERIOR ISO R PLUS premium

RIGID INSULATION PANEL MADE OF NEOPOR® WITH A LAMINATED REFLECTIVE VAPOR BARRIER MEMBRANE

- Ideal when interior insulation is required.
- Superior insulation: made of NEOPOR®, by BASF-SE. Eliminates thermal bridges from the inside.
- Creates a continuous insulating vapor barrier envelope. No other membrane needed.
- Vapor barrier and break resistant product.
- Membrane reflects radiant energy.
- Lightweight, flexible and no cutting dust.
- Easy to install on the ceiling.



#### DIMENSIONS

48" x 97 1/4" | Butt edge  
1/2" (R2.3\*) 3/4" (R3.5\*) 1" (R4.6\*)  
\*More details about assemblies including reflective effect at [www.us.isolofoam.com](http://www.us.isolofoam.com).

## UNDER SLAB INSULATION

### iFLEXFOAM

RIGID INSULATION PANEL WITH A LAMINATED MEMBRANE ON EACH SIDE

- Ensure continuous and uniform insulation with the unique **ISOCLICK** 4-sided clipping system: once installed, panels are clipped together and remain in place during installation.
- Flexible and resistance to breakage.
- High resistance to freezing, thawing, water and moisture.
- Excellent compressive strength: 16 psi (110 kPa), 30 psi (210 kPa).
- Fast and easy to install.

Patent pending product



#### DIMENSIONS

48" x 96" | **ISOCLICK** 4 sides  
**160** : 1 1/4" (R5) 1 7/8" (R7.5) 2 1/2" (R10)  
**300** : 1.2" (R5) 1.8" (R7.6) 2.4" (R10.1)

## FOUNDATION WALLS

### ISOFOIL

RIGID INSULATION PANEL WITH A LAMINATED REFLECTIVE VAPOR BARRIER MEMBRANE

- Ensures a continuous insulation and eliminates thermal bridges: improves comfort in the basement and reduces energy loss.
- Vapor barrier product: membrane reflects 95% of radiant energy.
- Blends with imperfections in the concrete: reduces the risk of condensation, mildew and wall deterioration.
- Fast and easy to install thanks to its integrated membrane.



#### DIMENSIONS

48" x 96" or 48" x 100" | Shiplapped 2 sides  
1" (R4\*) 2" (R8\*) 3" (R12\*)

More details about assemblies including reflective effect at [www.us.isolofoam.com](http://www.us.isolofoam.com).

## VERSATILE INSULATION

SLAB | FOUNDATION | WALL  
FLOOR | CEILING

### ISOLOFOAM HD 160 XHD 300

HIGH DENSITY INSULATION PANEL

- High and permanent insulation value.
- Economical, efficient and versatile product suitable for a number of applications.
- Non vapor barrier; can be installed on the exterior of walls.
- Excellent compressive strength: 16 psi (110 kPa), 30 psi (210 kPa).
- High resistance to freezing, thawing, water and moisture.
- Frequently used for below grade applications.



#### DIMENSIONS

24" x 96" or 48" x 96", 108", 112" | Shiplapped 4 sides  
**HD 160** : 1 1/4" (5) 1 7/8" (R7.5) 2 1/2" (R10)  
**300** : 1.2" (R5) 1.8" (R7.6) 2.4" (R10.1)  
Also available: other thicknesses; shiplapped 2 sides or butt edge.

## RADIANT FLOOR INSULATION

### ISORAD V2

RADIANT FLOOR HEATING INSULATION

- Ensure a continuous and uniform insulation:
  - Panels stay aligned and in place with the **ISOCLICK ALIGN** 4-sided clipping system.
  - Prevents heat loss through the soil. Provides permanent energy savings.
- Starting arrow and cutting lines for easy installation.
- Multidirectional tube retaning design for 1/2" and 5/8" tube.
- Overall savings of more than 20% with **ISORAD V2** compared to a traditional installation.

Patent pending product



#### DIMENSIONS

48" x 48" | **ISOCLICK ALIGN** 4 sides  
**160** : 2 1/2" (R10) 3 3/4" (R15)  
**300** : 2 1/2" (R10.5) 3 3/4" (R15.8)  
For 1/2" tube (Ø int. 1/2", Ø ext. 5/8") or 5/8" tube (Ø int. 5/8", Ø ext. 3/4").  
Also available: 24" x 48".





# A PARTNER OF CHOICE

## EXPERTS AT FINDING SOLUTIONS

Isolofoam Group is renowned for its innovative and responsible thermal insulation solutions. The company has been investing in expanded polystyrene product research and development for more than 40 years.

Its insulation solutions are tried and tested and meet the highest insulation requirements in the industry.

Isolofoam Group is proud to offer construction and renovation specialists, dealers and consumers a complete line of products that stands out in the market.



1346, Vachon Nord Blvd, Sainte-Marie  
(Quebec) Canada G6E 1N4

1-800-463-8886 | [us.isolofoam.com](http://us.isolofoam.com)