

ISOBRACE OSB

Composite panel consisting of expanded polystyrene insulation laminated to a perforated 7/16" Oriented Strand Board (OSB).

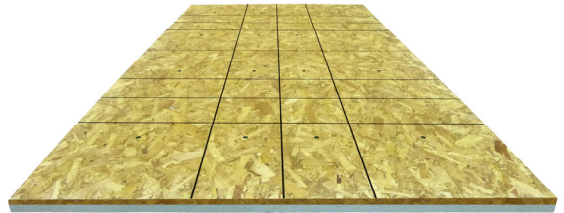

- Contributes to the structural strength of the building's walls.
- Eliminates thermal bridging: provides continuous insulation.
- Perforated OSB panel to increase water vapor permeability.
- Fast and easy installation.

Structural Insulating Panel - Installation

1| Panel orientation - two methods

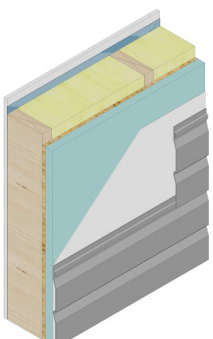
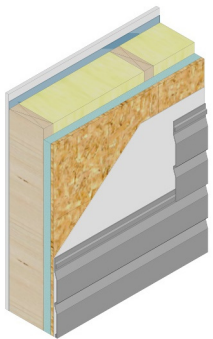
OSB against frame	Insulation against frame																		
<ul style="list-style-type: none"> • Requires that the nail heads are driven through the insulation and firmly pressed against the OSB. 	<ul style="list-style-type: none"> • Allows use of a standard fastening tool. Enables the OSB panel to be used as a nailing base for cladding. Provides additional bracing strength when interior finish is installed in conformance to wall bracing requirements. 																		
<table border="1"> <thead> <tr> <th colspan="3">Required Nail Length</th> </tr> <tr> <th>1 5/16" panel</th> <th>1 9/16" panel</th> <th>2 3/16" panel</th> </tr> </thead> <tbody> <tr> <td colspan="2" style="text-align: center;">2 3/8" to 2 1/2" <i>According to manufacturer of nailer for structural insulating panels.</i></td> <td style="text-align: center;">N/A</td> </tr> </tbody> </table>	Required Nail Length			1 5/16" panel	1 9/16" panel	2 3/16" panel	2 3/8" to 2 1/2" <i>According to manufacturer of nailer for structural insulating panels.</i>		N/A	<table border="1"> <thead> <tr> <th colspan="3">Required Nail Length</th> </tr> <tr> <th>1 5/16" panel</th> <th>1 9/16" panel</th> <th>2 3/16" panel</th> </tr> </thead> <tbody> <tr> <td style="text-align: center;">Min. 2 7/8"</td> <td style="text-align: center;">Min. 3 1/8"</td> <td style="text-align: center;">Min. 3 3/4"</td> </tr> </tbody> </table>	Required Nail Length			1 5/16" panel	1 9/16" panel	2 3/16" panel	Min. 2 7/8"	Min. 3 1/8"	Min. 3 3/4"
Required Nail Length																			
1 5/16" panel	1 9/16" panel	2 3/16" panel																	
2 3/8" to 2 1/2" <i>According to manufacturer of nailer for structural insulating panels.</i>		N/A																	
Required Nail Length																			
1 5/16" panel	1 9/16" panel	2 3/16" panel																	
Min. 2 7/8"	Min. 3 1/8"	Min. 3 3/4"																	

- To ensure product's structural rigidity, nails must be firmly seated against the Oriented Strand Board (OSB).
 - ◊ In areas requiring resistance to seismic forces, installer must verify and confirm the applicable bracing requirements.
- Good building practices recommend leaving a 1/8" gap between OSB panels.
- Using 48" x 108" panels allows insulation of joists and headers.

2 | Nailing

- Attach the panels with appropriate nails.
 - ◊ Common, spiral or ring nails shall be used.
- Recommended spacing between nails
 - ◊ 6" o/c along edge supports, max.
 - ◊ 12" o/c along intermediate supports, max.

3 | Air / weather tightness

- Install the air/weather barrier membrane.
- Seal all discontinuities in sheathing surface (e.g. penetrations, electrical fixtures, plumbing equipment) and ensure air and water tightness at openings (e.g. windows, doors).
- Install exterior cladding.

Details on page 2.

ISOBRACE OSB

Tools & Accessories

- Hand saw.
- Hammer and/or drill.
- Specialized or standard pneumatic fastening tool.
- Common, spiral or ring nails.
- Wood furring (optional).
- Air/weather barrier membrane.
- Sealing tape.
- Exterior cladding.

OSB against frame

Specialized Fastening Tool

If **ISOBRACE OSB** is installed with OSB against the frame, installer can use a specialized fastening tool such as SENCO's SCN63LDXP or equivalent. This nailing system ensures that the sheathing nails are secured with their heads seated on the surface of the OSB. **STANDARD NAILERS MUST NOT BE USED FOR THIS INSTALLATION METHOD.**

- Only use SENCO's SCN63LDXP nailer. Not suitable for 2 3/16" **ISOBRACE OSB**.
- Use the 3/8" thick R3 spacer on the SENCO SCN63LDXP nailer when fastening 1 5/16" and 1 9/16" **ISOBRACE OSB**.
- Only use SENCO 2-3/8" x 0.113" 15° GL24APBF nails for installation.

ISOBRACE OSB Nailing Pattern

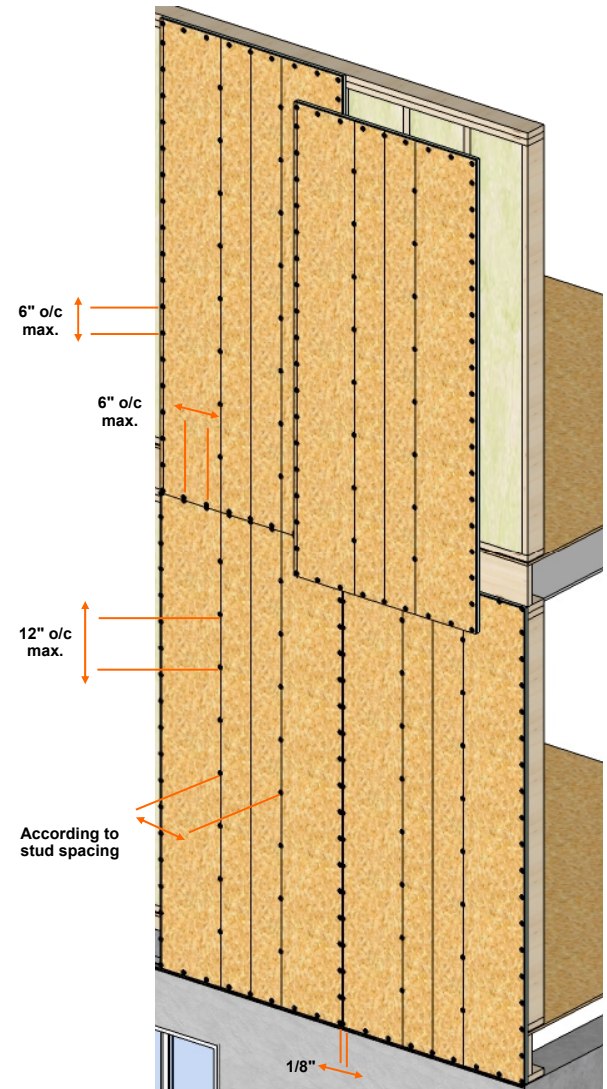

For technical details, refer to the Product Data Sheet.

Limitations

Combustible if exposed to an open flame or other substantial and sustained source of ignition. Avoid contact with petroleum-based solvents or their vapors. Avoid prolonged exposure to direct sunlight.

Safety

Product Safety Data Sheets are available on the Isofoam Group website. Dust mask has to be used to avoid breathing dust generated from sanding or cutting the product. The product is combustible and should be protected from ignition sources such as open flames or welding torches. For fire safety, insulation must be separated from interior by a thermal barrier such as drywall or concrete.

Storage specifications

When possible, indoor storage is recommended. If stored outdoors, cover the panels with a plastic sheeting (tarp) to protect them from bad weather and ultraviolet rays. Cover must allow air circulation. Store and handle panels flat. Use at least three (3) supports on the 8-foot length, one at center and the others at approximately 16" from ends to reduce the risks of deformation. Product must be stored at least 4" from the ground.

Exemption of liability

Information and data contained in the present document are offered in good faith based on information we believe to be reliable. This document contains no representations or warranties expressed or implied as to the information data or suggestions. Reference is made to the terms and conditions under which above mentioned products are sold. All suggestions must be adapted as to their application and consequently modified, if necessary, to comply with applicable laws and legislations. Illustrations for information purposes only.